

Source 1 Input
120VAC/60Hz 30A

Source 2 Input
120VAC/60Hz 30A

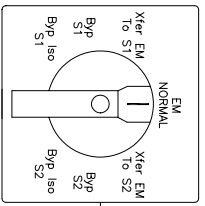

Maintenance Bypass Switch

Maint. Bypass Switch Closure	Position	Contact	A1	A2	A3	A4	A5
	BYP ISO 1		X				
	BYP 1			X			X
	XFER EM 1		X				
	Normal						
	XFER EM 2			X			X
	BYP 2		X				
	BYP ISO 2				X		

Contacts A2,A3 and A3,A4 are overlapping

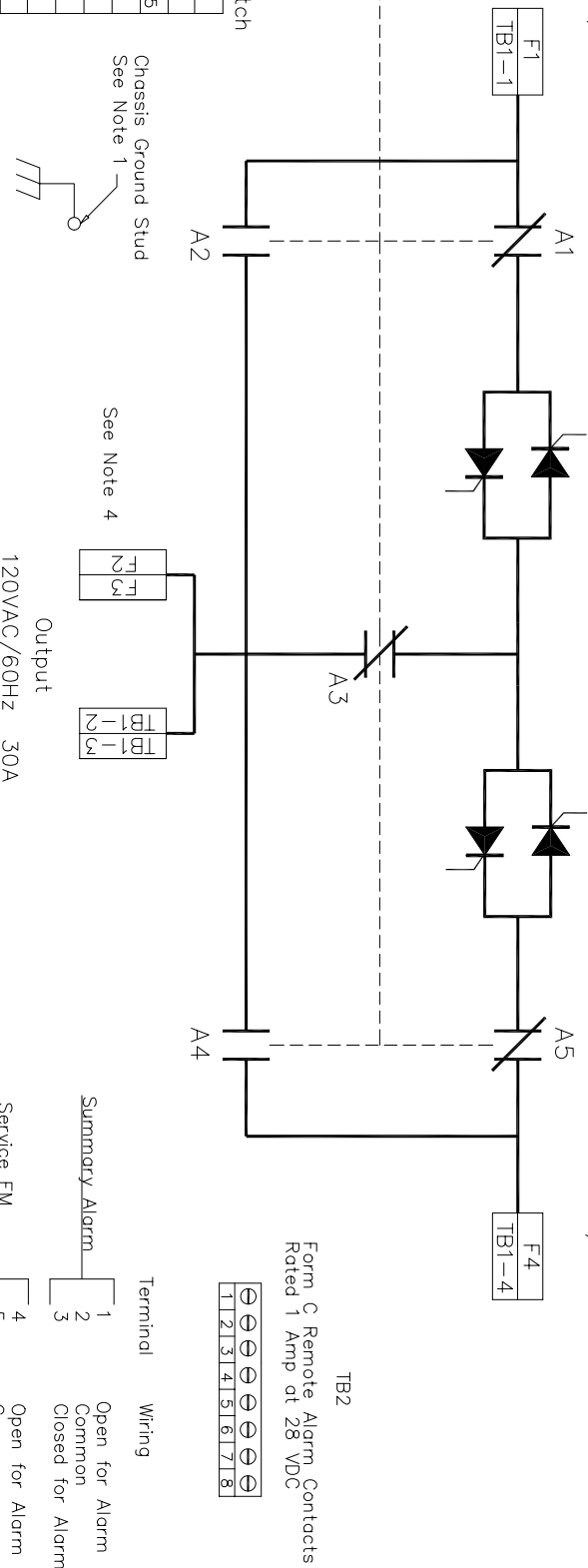

Suitable for control of motors, electric discharge lamps, tungsten filament lamps, and electric heating equipment where the sum of the motor full-load ampere ratings and the ampere ratings of other loads do not exceed the ampere rating of the switch and the tungsten load does not exceed 30 percent of the switch rating.

Fuse Information:

F1 & F4: use TCF50 fuses ONLY
F2 & F3: use KLDRI0, 20 or 30 fuses

Notes:

- 1) Ensure chassis ground stud is bonded to a suitable Earth ground
- 2) Communication Connection not on all models. See Manual for TB3 connections to Host Computer
- 3) Sources are recommended to be connected in phase
- 4) Ensure load on individual output fuses does NOT exceed 20A and combined load does NOT exceed 30A

Power Wiring Connection List

Terminal	Signal
F1	Source 1 input H
TB1-1	Source 1 input N
F2	Output 1 H
F3	Output 2 H
TB1-2	Output 1 N
TB1-3	Output 2 N
TB1-4	Source 2 input N
F4	Source 2 input H

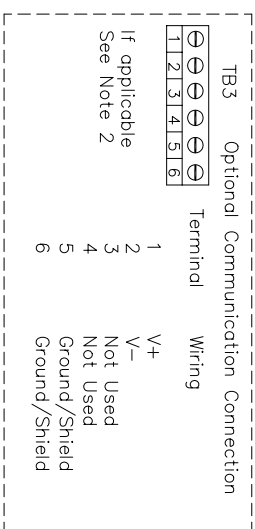
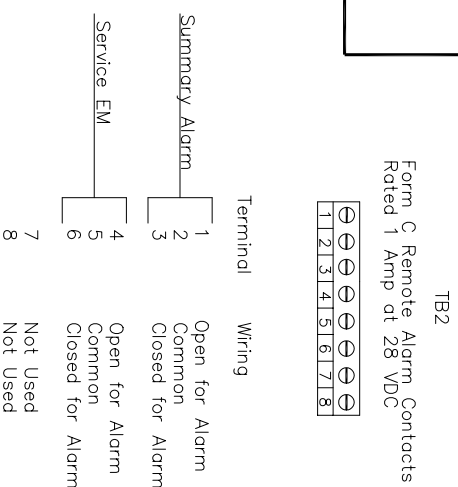

TwinSource
32335 Aurora Road Suite 50
Solon, Ohio 44139 U.S.A.
Phone 440-248-6800 Fax 440-349-2678

CUSTOMER:	(customer name)	JOB NUMBER
P.O. NUMBER	SCALE	ISSUE: A
(po number)	N/A	BY DPM
	APPVD: DPM	DATE: (date)
DRAWING DESCRIPTION	ONLINE AND CONNECTION DIAGRAM	DRAWING NUMBER
30 Amp Dual Cord Converter		C612030-1
		SHEET 1 OF 1

This Document is proprietary to TwinSource LLC. Duplication, Distribution or use for any purpose other than permitted by TwinSource in writing is strictly prohibited. Drawing subject to change without notification.

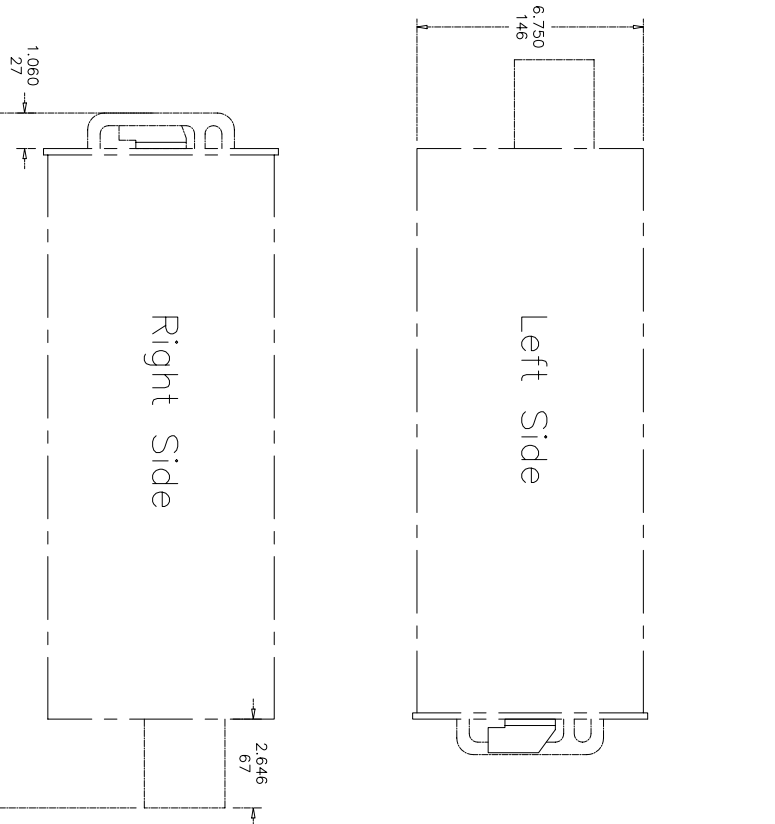
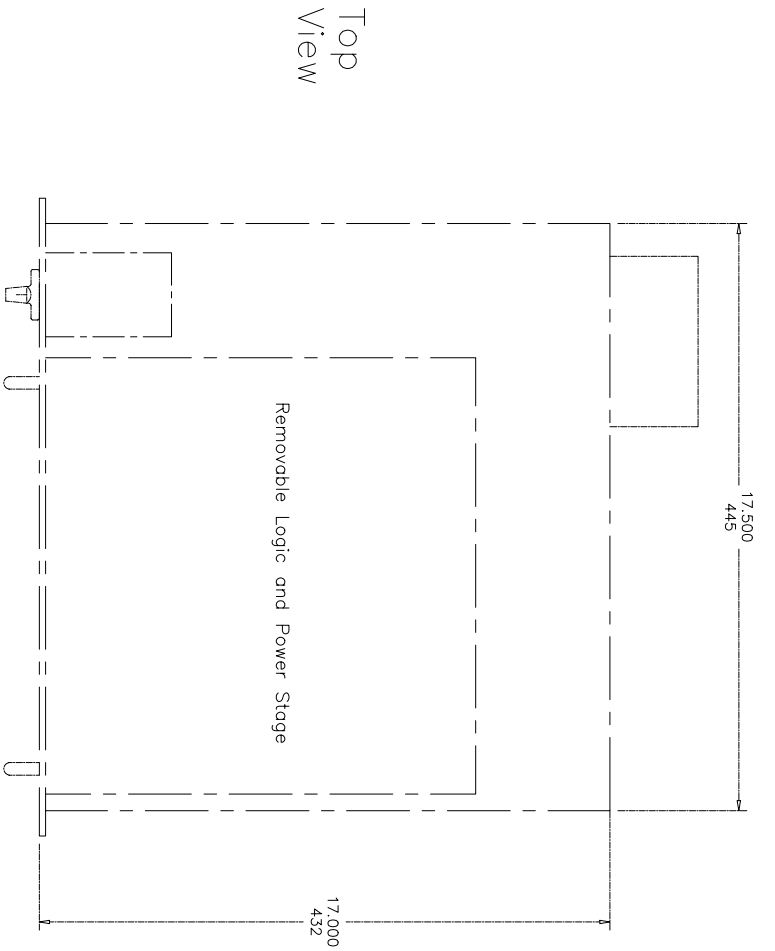

Top View

Front View

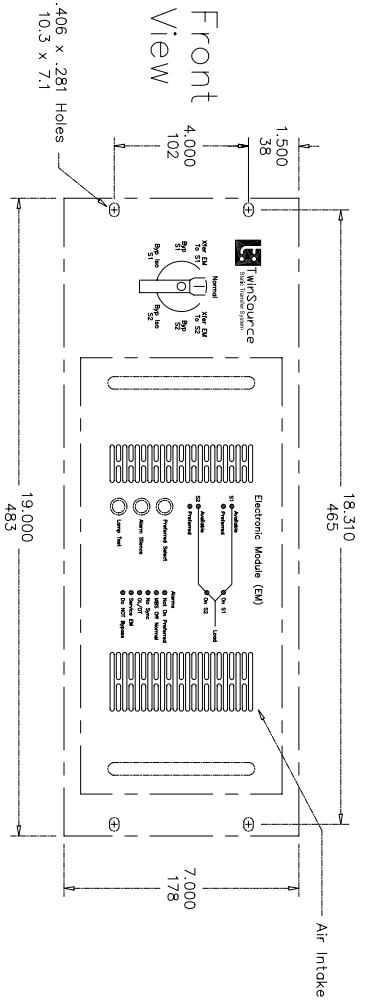

Rear View

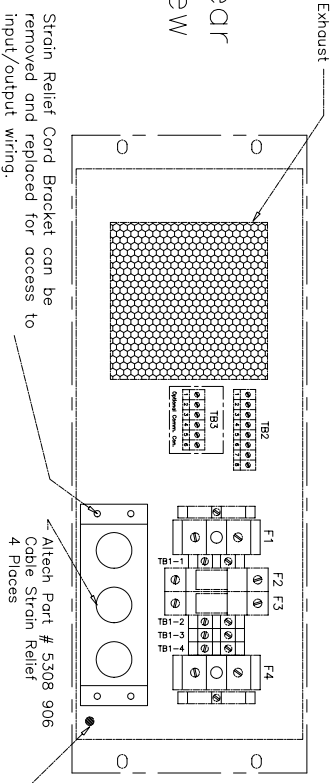

Mechanical:

TYPE-I Enclosure
 Dimensions in inches/mm.
 Tol. ±.0156in/.396mm unless noted.
 Weight 49lb/22kg.
 Complies with EIA Standard 310-D 4U Panel Mounting Specs.
 Recommended Mounting Hardware: 10-32 Class UNF-2B, 12-24 Class UNC-2B, MSX.8-6H or M6X1-6H Thread.
 Finish = Sherwin Williams RAL 7015 Texture Powder Coating
 Sherwin Williams Project # 01F-048 Dark Gray

Clearance Requirements:

Front 36in/914mm for Electronic Module (EM) replacement
 Rear 6in/152mm for exhaust air
 Left None
 Right None
 Top None
 Bot None

Wire and Torque Specifications:

F1, F4 Use max 8 AWG at 40 in/lb
 F2, F3 Use max 8 AWG at 15 in/lb
 TB1 Use 14-8 AWG at 17.5 in/lb
 TB2-TB3 Use 26-14 AWG at 4.5 in/lb
 Use min 75C rated copper wire ONLY

Environment:

Operating temperature range 0 to 40°C.
 Humidity up to 95% Non-Condensing.
 Dust and chemical free environment.
 CE and UL Listed.

This Document is proprietary to TwinSource LLC. Duplication, Distribution or use for any purpose other than permitted by TwinSource in writing is strictly prohibited. Drawing subject to change without notification.



32333 Aurora Road Suite 50
 Solon, Ohio 44139 U.S.A.
 Phone 440-248-6800 Fax 440-349-2678

CUSTOMER: (customer name)		JOB NUMBER (job number)	
P.O. NUMBER	SCALE	ISSUE: A	BY DPM
(po number)	N/A	APPVD: DPM	DATE: (date)
DRAWING DESCRIPTION		DRAWING NUMBER	
30 Amp Dudi Cord Converter		C612030-2	
SHEET 1		OF 1	